

800 Cochran Avenue
Cambridge, Ohio 43725
Tel: 740.439.2338
Toll Free: 800.233.4383
Fax: 740.439.0121

Specifying Super Spacer®

PART 1 - GENERAL

References (contact Quanex for details)

1. North America ASTM E2188/E2189/E2190
2. European EN 1279
3. Canadian CGSB 12.8
4. ASTM E330 (120* psf positive, 155* psf negative)
5. French Standard CSTB for CEKAL
6. Industry type P-1 testing
7. Quanex is an ENERGY STAR® partner

System Description

Super Spacer is a flexible, silicone spacer providing maximum perimeter insulation for sealed insulating glass units. It is desiccant filled with pre-applied adhesive for bonding to the glass with a vapor barrier backing.

Submittals

Super Spacer® TriSeal™ features a continuous vapor barrier backing across the profiled back of the spacer, and is engineered to accept both a butyl primary seal and a silicone secondary seal.

1. Thermoset structural silicone spacer containing NO-Metal with integral 3A desiccant
2. PIB primary seal
3. Silicone, Polyurethane, Polysulfide, DSE/DSA's or Hot Melt secondary seal
4. Pressure-sensitive acrylic adhesive
5. Pre-applied advanced multi-layer vapor barrier

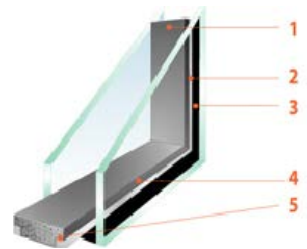

Super Spacer® Premium Plus and Premium are flexible, silicone spacers that provide the maximum in perimeter insulation for sealed glazing units.

1. Thermoset structural silicone containing NO-Metal with integral 3A desiccant
2. Pre-applied sealant/adhesive for glass bonding
3. Secondary Sealant
4. Pre-applied advanced multi-layer vapor barrier

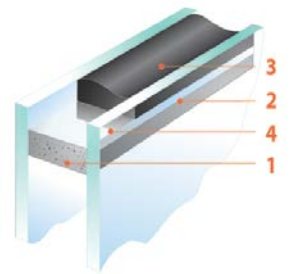



800 Cochran Avenue
Cambridge, Ohio 43725
Tel: 740.439.2338
Toll Free: 800.233.4383
Fax: 740.439.0121

Quality Assurance

Quanex is an Energy Star® Partner. The company has also earned the Solar Company of the Year Award from the Solar Energy Society of Canada Inc. and the Crystal Achievement Award for various marketing programs.

Warranty

Quanex warrants that the Product (Super Spacer Premium Plus, Premium, and/or TriSeal) will be free from manufacturing defects at the time of shipping from Quanex. Further, Quanex agrees to replace any Product (Super Spacer Premium Plus, Premium, Super Spacer and/or TriSeal) that fails because of manufacturing defect. Super Spacer Premium Plus, Premium, and/or TriSeal are guaranteed not to blister or bubble within 40 years of purchase.

This warranty applies under conditions of normal use by window manufacturers and does not apply to defects that result from intentional damage, improper storage or excessive exposure prior to use. This warranty does not apply to edge-seal workmanship, which is the responsibility of the insulating glass manufacturer.

PART 2 – PRODUCTS

Manufacturer

Quanex Building Products – IG Systems • 800 Cochran Avenue • Cambridge, Ohio 43725
T: 740.439.2338 • Toll Free: 866.TRUEWARM • F: 740.439.0121
www.quanex.com

Edgetech UK • Stonebridge House, Rowley Drive • Stonebridge Trading Estate
Coventry, England CV3 4FG • T: +44 (0) 2476 639931 • F: +44 (0) 2476 639727
www.superspacer.co.uk

Edgetech Europe GmbH • Gladbacher Strasse 23 • 52525 Heinsberg • Germany
T: +49 (0)2452.96491.0 • F: +49 (0)2452.96491.11
www.superspacer.com

800 Cochran Avenue
Cambridge, Ohio 43725
Tel: 740.439.2338
Toll Free: 800.233.4383
Fax: 740.439.0121

Insulating Glass Units

Specification Description:

Super Spacer TriSeal—a triple seal design suitable for Structural Glazing, consisting of a thermoset silicone spacer incorporating integral 3A desiccant, pre-applied adhesive for glass bonding, a captive polyisobutylene primary seal, and a structural seal.

Super Spacer—a reverse dual seal design consisting of a thermoset silicone spacer, multi-layer vapor barrier and preapplied sealant/adhesive for glass bonding requiring a secondary seal.

Please refer to <http://www.quanex.com/Service-and-Support/Technical-Library/Tech-Bulletins> for verified IG sealants Technical Bulletin RD0018.

Super Spacer Selection

Architectural Structural and Captured Glazing Units

Super Spacer TriSeal™

Available Sizes: 0.323" (8.2mm) to 0.874" (22.2mm) airspace
Standard Color: Black, Grey and Aluminum Grey
Optional Colors: Are Available (Minimum Order Required)
Custom Options: As defined by Specifier (Minimum Order Required)

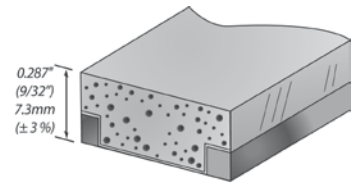

Architectural Captured Glazing Units

Super Spacer Premium Plus - Recommended for IG greater than 65 sq. ft. (6m²)

Available Sizes: 0.125" (3.2mm) to 0.787" (20.0mm) airspace
Standard Colors: Black, Grey and Aluminum Grey
Optional Colors: Are Available (Minimum Order Required)
Custom Options: As defined by Specifier (Minimum Order Required)

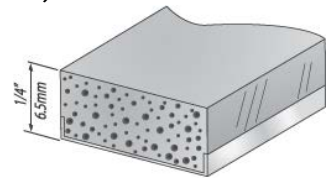

Super Spacer Premium

Available Sizes: 0.188" (4.8mm) to 0.787" (20.0mm) airspace
Standard Colors: Black, Grey and Aluminum Grey
Optional Colors: Are Available (Minimum Order Required)
Custom Options: As defined by Specifier (Minimum Order Required)

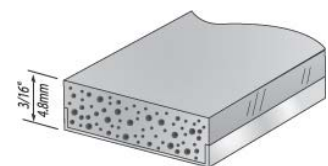



800 Cochran Avenue
Cambridge, Ohio 43725
Tel: 740.439.2338
Toll Free: 800.233.4383
Fax: 740.439.0121

PART 3 – EXECUTION

Installation

No special procedures required for IG units fabricated with the Super Spacer system; limit spacer compression at installation to 1mm.

Field Quality

No special inspection procedures required for IG units fabricated with the Super Spacer system.

Protection

Follow usual requirements for protecting IG units.